

## Hardened Industrial 100Base-FX Single-Mode SC Fiber Converter (30 km, 18.6 mi.)

TI-F10S30 (v1.0R)

- Hardened IP40 rated compact housing
- 100Base-FX Single-Mode fiber over distances of up to 30 km (18.6 mi.)
- SC-type fiber port
- Extreme -40 to 75 °C (-40 to 167 °F) operating temperature range
- Overload current protection
- Includes DIN-rail and wall mounts
- Power supply sold separately (model TI-M6024)

TRENDnet's TI-F10S30 is a compact IP40 rated 100Base-FX fiber converter with hardened components rated for extreme industrial environments. It accommodates long distance networking with 100Base-FX Single-Mode fiber over distances of up to 30 km (18.6 miles). Both DIN-rail and wall mount hardware is included. Power supply sold separately: model TI-M6024.



### Network Ports

1 x 10/100 Mbps Ethernet port and 1 x 100Base-FX SC-type fiber port



### Fiber

100Base-FX Single-Mode fiber over distances of up to 30 km (18.6 miles)



### Dip Switches

Dip Switch 1: Enable/disable Link Fault Pass Through (LFP) support  
Dip Switch 2: Converter mode or switch mode



### DIN-Rail/Wall Mounts

IP40 rated metal enclosure with included DIN-Rail and wall mount hardware



### Extreme Temperatures

Hardened converter is rated for an operating temperature range of -40 to 75 °C (-40 to 167 °F)



### LED indicators

LED indicators confirm network connectivity

## Networking Solution

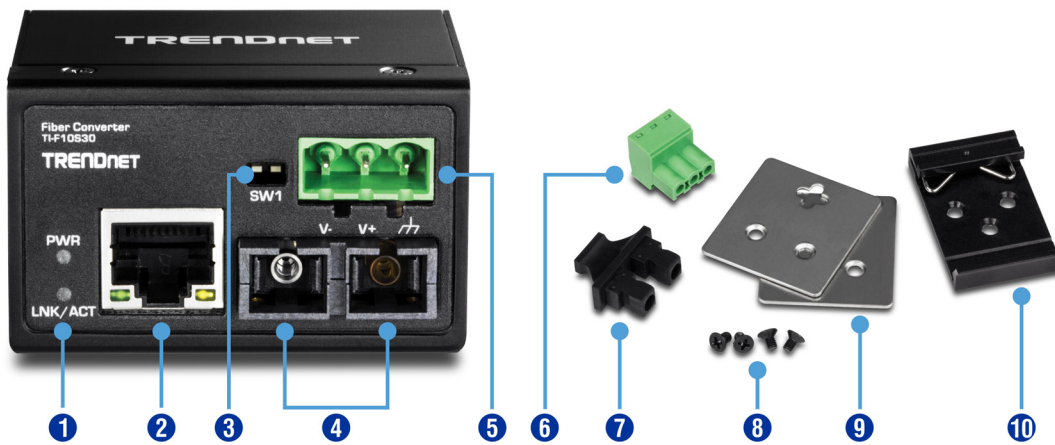

- 1 LED indicators
- 2 100M Ethernet port
- 3 DIP switch
- 4 Single-mode fiber port
- 5 Terminal block slot
- 6 Terminal block
- 7 Dust cap
- 8 Screws
- 9 Wall mounting kit
- 10 DIN-Rail mount

## Specifications

### Standards

- IEEE 802.3
- IEEE 802.3u
- IEEE 802.3x

### Device Interface

- 1 x 10/100 Mbps port
- 1 x 100Base-FX port (SC-type)
- 3-pin terminal block
- LED indicators
- DIN-Rail mount
- Wall mount
- Grounding point

### Data Transfer Rate

- Ethernet: 10 Mbps (half duplex), 20 Mbps (full duplex)
- Fast Ethernet: 100 Mbps (half duplex), 200 Mbps (full duplex)

### Special Features

- Hardened components rated for extreme temperatures
- Auto-Negotiation
- Link Fault Pass Through (LFP)
- Converter mode, switch mode
- ESD 8 KV and Surge 6 KV protection

### Fiber

- Media: Single-mode SC connector
- Cable: 62.5 / 125 or 50 / 125  $\mu$ m
- Wavelength: 1310 nm
- Optical Output Power (dBm): -15 ~ -8
- Optical Input Power (dBm): -34 ~ 0
- Power Budget: 7
- Distance: 30 km

### Power

- Input: 12 – 60 V DC or 18 – 36 V AC
- Compatible power supply: TI-M6024 (sold separately)
- Consumption: Max. 1.92 Watts

### Terminal Block

- Redundant power inputs, 3 pin
- Wire range: 0.34 mm<sup>2</sup> to 2.5 mm<sup>2</sup>

- Solid wire (AWG): 12-24/14-22
- Stranded wire (AWG): 12-24/14-22
- Torque: 5 lb. – In / 0.5 Nm / 0.56 Nm
- Wire strip length: 7 – 8 mm

### MTBF

- 510,304 hours

### Housing

- IP40 metal case
- DIN-rail mount
- Wall mount
- Grounding point
- 8 KV ESD protection
- 6 KV surge protection

### Operating Temperature

- -40 to 75 °C (-40 to 167 °F)

### Operating Humidity

- Max. 95 % non-condensing

### Dimensions

- 60 x 50 x 35 mm. (2.4 x 2 x 1.4 in.)

### Weight

- 90 g (3.2 oz.)

### Certifications

- CE
- FCC
- Shock (IEC 60068-2-27)
- Freefall (IEC 60068-2-32)
- Vibration (IEC 60068-2-6)

### Warranty

- 3 year limited

### Package Contents

- TI-F10SC30
- Quick Installation Guide
- Removable terminal block
- DIN-rail / wall mount kit

