



## Adapter Sub-D 9 pin male > female 90° angled

### Description

This serial adapter by Delock enables you to lead the female port of your serial device 90° angled. Thus you can connect your serial cable without any problem in case the existing serial female port is difficult to access.



Ref.	65264
EAN	4043619652648
Country of origin	China
Customs tariff number	84718000

### Images

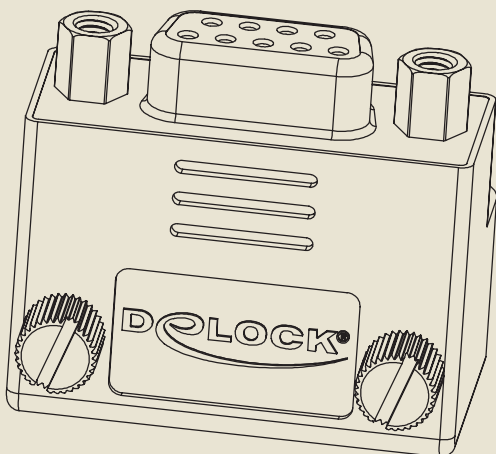
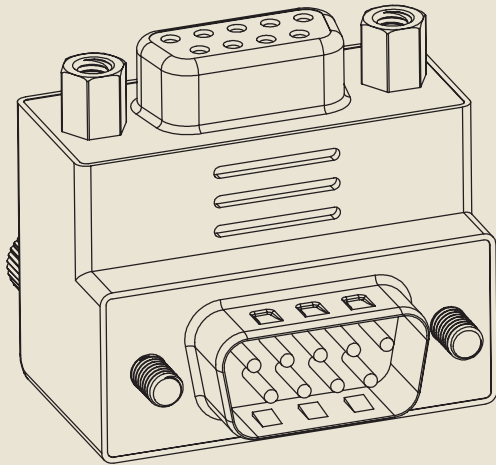

### Specification

- Connector: Sub-D 9 pin male > Sub-D 9 pin female
- Female port 90° angled
- Sub-D 9 female with screw nuts
- Sub-D 9 male with screws

#### Package content

- Adapter Sub-D 9 pin

#### Package

- Delock poly bag